

Kinetrol Explosion Proof P3 On/Off Positioner



ATEX Category 2

The explosion proof P3 on/off positioner offers a robust three position rotary control device with a fast, smooth, accurate response in a compact corrosion resistant, aluminium housing.

The unit is available ATEX approved to Category 2 and offers four voltages, many switch options and angle position feedback. Available for close mounting on Kinetrol actuator models 05 to 15 or discrete mounting via a Kinetrol 05 square or NAMUR drive.

Please refer to P3 On / Off Positioner data sheet for product details.

Specification

European / Global Protection ATEX / IECEx Approval

Exd Group IIC Category 2
Gas & Dust T5, IP66

Voltages

115V ac
24V dc

Working Temperature Range

-20°C to +60°C (-4°F to +140°F)

Power Consumption

positioner 1.5 W max.
solenoids 5 VA max. per
solenoid.

Selected External Inputs

4-20mA - impedance
250 ohm.
potentiometer - minimum
resistance 10K ohm.

Casing

precision diecast LM24 alloy,
anodised & epoxy thermoset powder.

Coupling

zinc plated steel or stainless
steel option.

Positioner Performance

linearity -
better than 1% of range
deadband -
0.1 to 3% of range
(subject to optimisation
of speed, deadband and
damping).

Optional 2-wire Angle Transducer

supply voltage -
8.5 to 27V dc
output -
4-20mA, linearly proportionate
to angular position, electrically
isolated from all other inputs
and outputs
functions with or without
positioner circuit energisation

Kinetrol Explosion Proof P3 On/Off Positioner

Ordering Codes

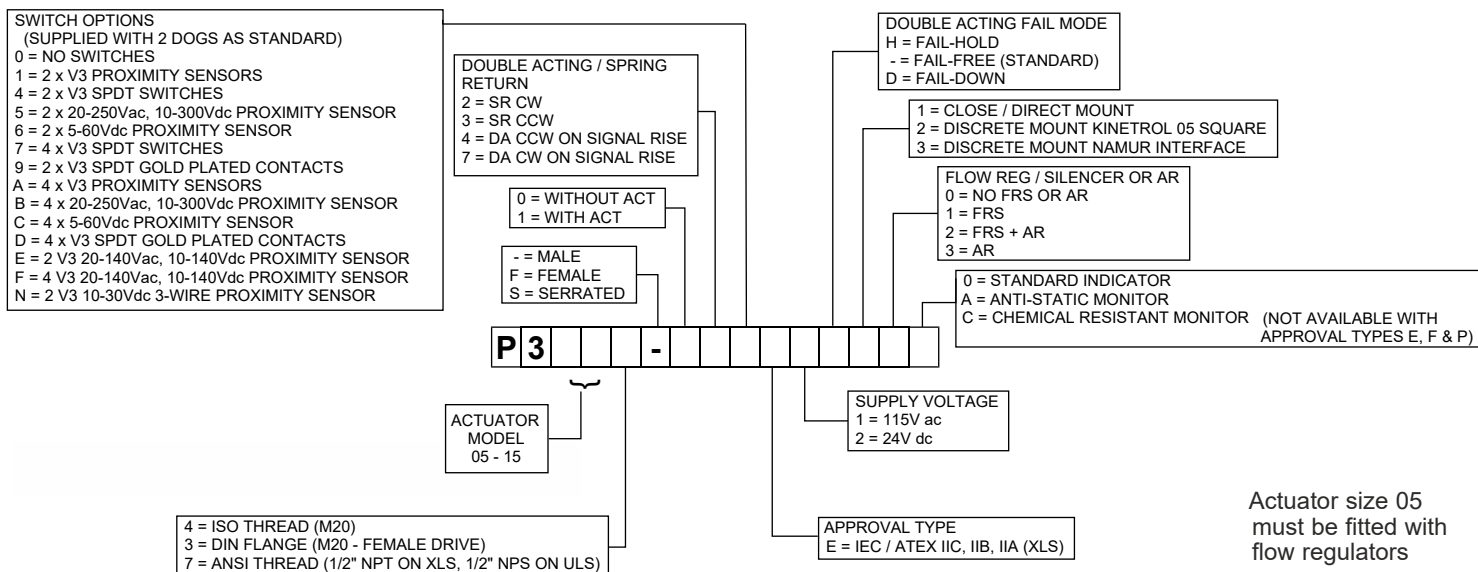

Dimensions

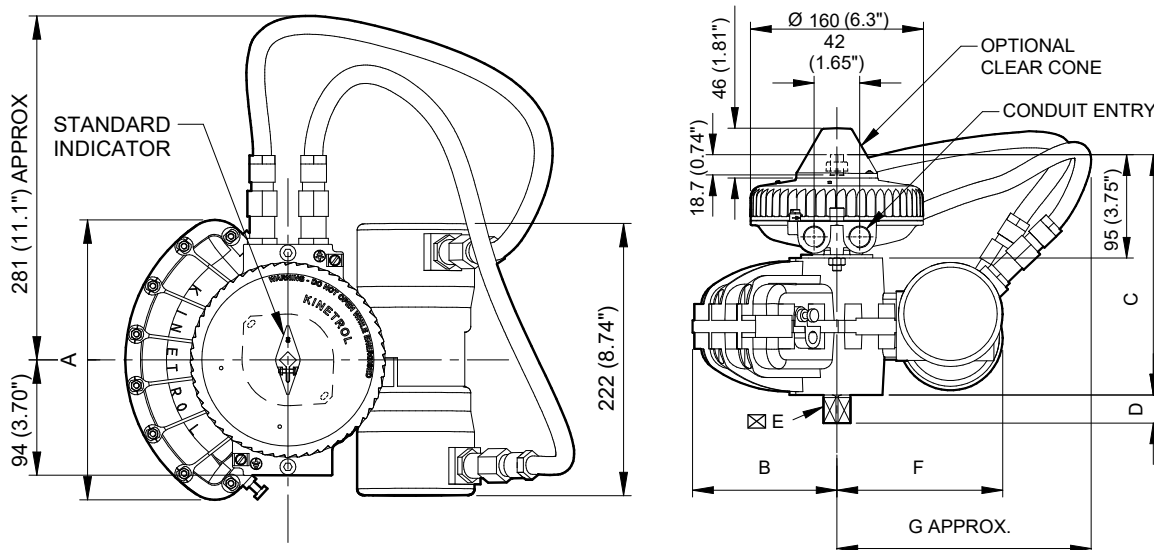

Model	A	B	C	D	⊠E	F	G
05	132.0 (5.20")	80.0 (3.15")	162 (6.4")	13.0 (0.51")	9.5 (0.375")	133 (5.2")	214 (8.4")
07	178.0 (7.01")	102.6 (4.04")	195 (7.7")	20.0 (0.79")	16.0 (0.630")	142 (5.6")	223 (8.8")
08	208.0 (8.19")	120.7 (4.75")	205 (8.1")	19.0 (0.75")	17.0 (0.669")	145 (5.7")	226 (8.9")
09	227.0 (8.94")	133.0 (5.24")	221 (8.7")	26.0 (1.02")	19.0 (0.748")	153 (6.0")	234 (9.2")
10	229.0 (9.00")	130.5 (5.14")	273 (10.75")	24.0 (0.94")	22.0* (0.870")	155 (6.2")	236 (9.3")
12	294.0 (11.57")	171.0 (6.73")	266 (10.5")	31.0 (1.22")	25.0 (0.984")	167 (6.6")	218 (8.6")
14	380.0 (14.96")	222.0 (8.74")	314 (12.4")	38.0 (1.50")	28.6 (1.125")	183 (7.2")	264 (10.4")
15	433.0 (17.05")	252.0 (9.92")	355 (14.0")	41.0 (1.61")	36.0 (1.417")	200 (7.9")	281 (11.1")

* Model 10 DIN (F10) Female Drive