

# Kinetrol Control Units & Top-Mount Accessories

## Modular Add-On Control Units

### Kinetrol modular concept easily provides the control assembly needed

(Please see separate data sheets for individual items)

#### 1. Visual Indicator

Gives visual indication of valve position as standard except models 0M0, 01, 16, 18, 21, 30 and 60.

#### 2. Clear Cone Monitor

Gives 360° and overhead position indication. Available on actuator models 03, 05, 07, 08, 09, 10, 12, 14, 15, limit switch boxes, AP positioners, EL positioners, P3 positioners and EHD models.

#### 3. I/P Controller

4-20mA electrical signal controls main air supply to pneumatic positioner as alternative to air signal control.

#### 4. AP Positioner

3-15psi (0.2-1 bar) air signal controls main air supply to turn, stop or hold the actuator vane in proportional response to that air signal. Limit switch and angle retransmit options available.

#### 5. EL Electropneumatic Positioner

A single unit gives smooth accurate control in response to a 4-20mA signal. Limit switch and angle retransmit options in same housing.

#### 6. DP3 Positioner

3 Position operation or 4-20mA modulation, fast, smooth, precise control and resilient to poorer quality air. Simple set up, quick calibration and loop powered angle retransmit as standard.

#### 7. Explosion Proof P3 On/Off Positioner

Provides the same basic options as the P3 Positioner but in a flame proof enclosure with ATEX approval.

#### 8. VLS/ULS Limit Switch Box

Weathertight unit with up to 4 switches for remote position indication or control use. Optional switches for flame proof/explosion proof needs and high visibility Clear Cone monitor.

#### 9. Explosion Proof Limit Switch Box

Provides the same basic options as the VLS/ULS Switch Box but in a flame proof enclosure with ATEX, FM and IEC approvals.

#### 10. Solenoid

Optional integral pneumatic solenoid valve for actuators. Various electrical, environmental and explosion proof requirements covered.

#### 11. Actuator

18 sizes covering torque range 0.1 Nm (1 lbf in) to 40765 Nm (356,977 lbf in). Operating air pressure range 1.4 bar (20 psi) to 7 bar (100 psi). Adjustable stops as standard. Restricted travel stops and ISO/DIN versions available.

#### 12. 180° Converter

Compact units give constant torque output through to 200° travel.

#### 13. Fail-Safe Spring Return Units

Clock type spring return gives reliable fail-safe operation with high torque output throughout spring stroke, yet has easy adjustment to suit application.

#### 14. Modular Fail-Safe Spring Return Unit

Clock type spring return unit with the ability for the direction of the spring to be reversed with only simple tools and completed in minutes - Models 07 & 15 only.

#### 15. Spring To Centre

Patented spring unit to provide accurate adjustable port travel position on loss of air/signal.

#### 16. ISO Adaptor

The patented ISO adaptor provides easy conversion from a Kinetrol male drive to an ISO flange interface for ultimate mounting flexibility.

#### 17. Gearbox

Geared manual override on all models from 05 to 21 excluding model 15.

#### 18. Mounting Bracket

A comprehensive range of brackets provides for most ball, plug and butterfly valves.

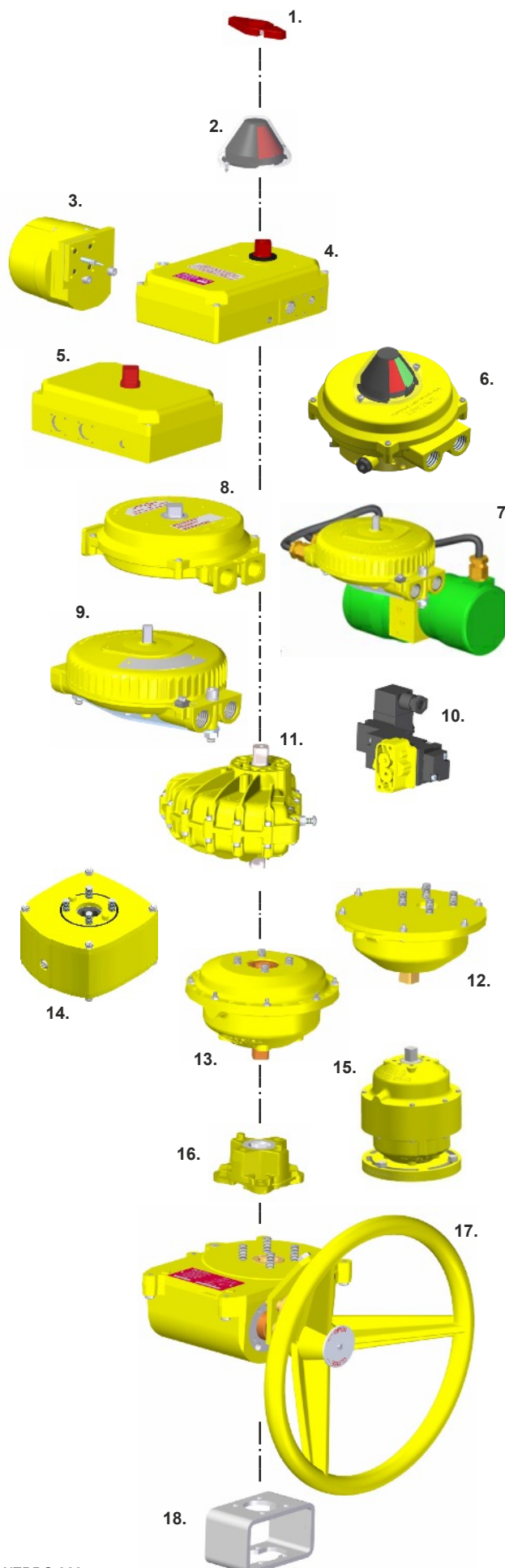

# Kinetrol Control Units & Top-Mount Accessories

## Models 03 & 05

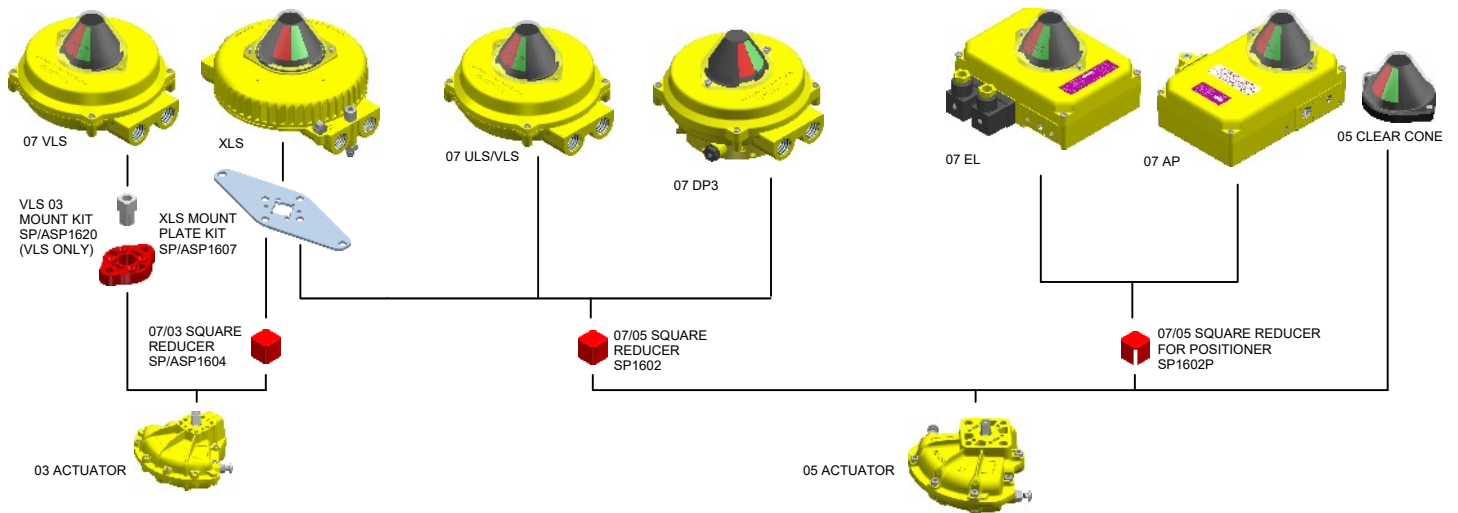

## Models 07 to 15

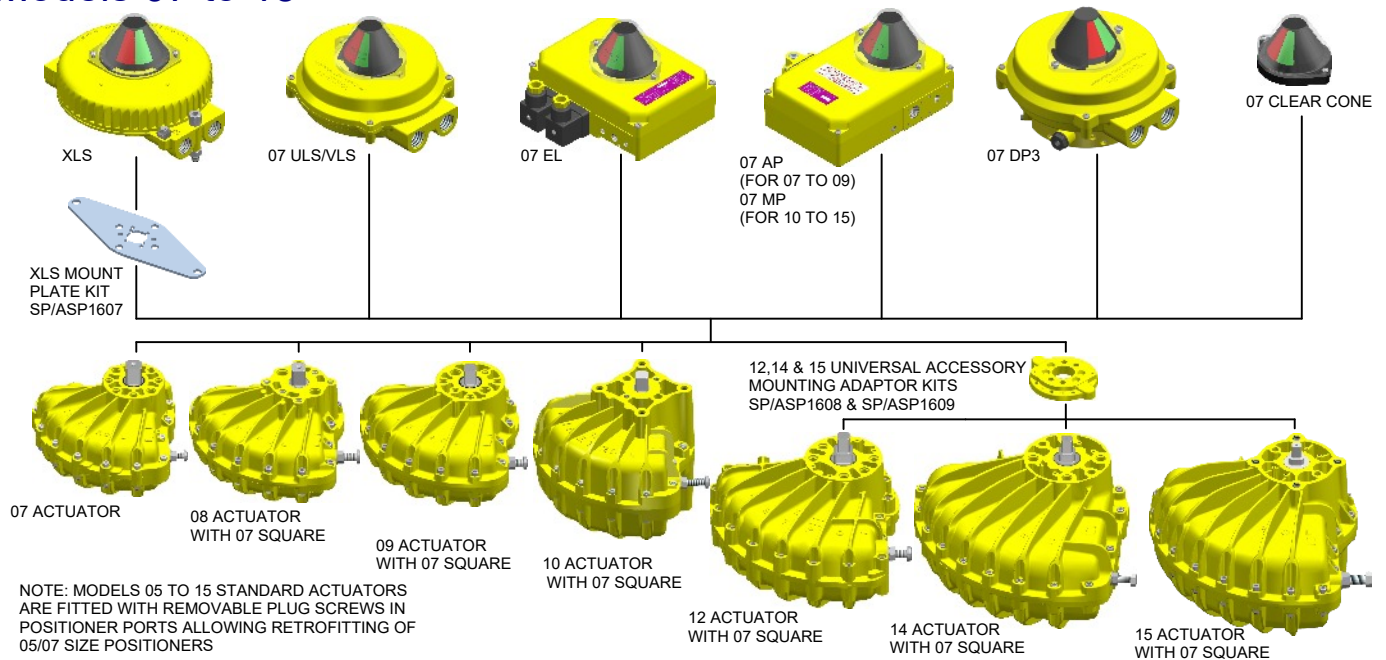

## Models 16 to 60

